

Aperio Online Escutcheon E100

ASSA ABLOY

DIN Version

Escutcheon with Aperio technology for inner doors for integration in Online Access Control

Characteristics

- Compatible to all (DIN) type European mortise locks
- Compatible to standard and tube frame doors
- Indoor use
- Door thickness from 40 ... 100mm in 6 steps
- outside handle free wheeling
- inside handle always connected
- main electronics (RFID+radio) outside
- secure electronics inside
- battery inside
- clutch mechanism inside
- mechanical cylinder (option)
- battery backup contact (option)
- Square spindles easily exchangeable
- Fixation with 3 bolts (2 as option – in preparation)
- LED for status visualisation (red / green)
- Communication hub with RS 485 bus to the EAC system (addressable)
- Access decision in the EAC system



1. Technical datas:

Dimensions H*W*D	312mm x 41mm x 10/20mm
Battery type	1* Lithium CR123A
Battery lifetime	> 40.000 cycles
Radio standard	IEEE 802.15.4 (2,4 GHz)
Encryption (radio communication)	AES 128 Bit
Distance between Escutcheon and hub	Recommended max 5m / same side of the wall
RFID technology	Mifare classic
RFID reading	UID / sector/block
Card reading distance	< 4cm
Operating Temp. range	0°C ... 60°C
Humidity	<85% non condensating
IP-degree	IP 30
Approvals	CE
Colour / surface	Stainless steel - brushed
Handles	L-form
Cylinder types (option)	Euro Profile / Swiss ovale
Distance between centres (cylinder-handle)	72/92/70/74/78/85/88/94
Square spindles	8mm / 9mm / 7mm (in preparation)
Backset	>40mm
Override	-Up to 10 override credentials / cards -Mechanical cylinder (option) -Battery contact 9V block battery (option)

2. Cylinder and Battery contact (battery backup) - options

Cylinders are part of the lock / door. The E100 Provides holes for the cylinder with no mechanical Fixation.

The battery contact allows powering of the E100 With a standard 9V battery block in case the build in battery is empty.



3. Visualisation (LEDs)

- access granted – green
- access denied – red
- battery warning – red blinking
- warning – red blinking
- Power off self test – red blinking sequence
- All status informations are also send to the EAC system

4. Setup

- The E 100 is an Aperio technology based electronic online escutcheon
- To set up the system (encryption key, override credentials, RS 485 bus address, reading type) the PAP installation software together with the USB radio dongle has to be used (see separate manual)
- PAP installation tool has to be ordered separately

5. Ordering information

15 digit order code

5001010-1120 E600, DIN, Aperio, RFID, Mifare, XXXX, stainless steel, handle, AA branding, version 1

1...3 Digit		500=Basic number for Standard Escutcheon
4. Digit	Version	1=DIN
5. Digit	Function	0=Aperio=wireless online
6. Digit	Identification	1=RFID
7. Digit	RFID technology	0 Mifare classic
8. Digit	square spindle	7=7mm 8=8mm 9=9mm
9. Digit	door thickness	A=40..50mm B=50..60mm C=60..70mm D=70..80mm E=80..90mm F=90..100mm
10. Digit	Cylinder	_ blind 1 EPC 3 Swiss round 22mm 4 battery backup 5 Swiss round outside, inside blind 6 EPC outside, inside blind
11. Digit	Distance between centres (handle – cylinder)	_ blind 0 72mm 1 92mm 2 74mm 3 94mm 4 70mm 5 78mm 6 88mm 7 85mm 8 105mm
12. Digit	Handle	1 Handle / Handle L-form 2 Handle / Handle U-form
13. Digit	Surface	1 stainless steel, brushed
14. Digit	Brand	2 ASSA ABLOY
15. Digit	Version	0 Version 1

6. Dimensional drawings – drilling template

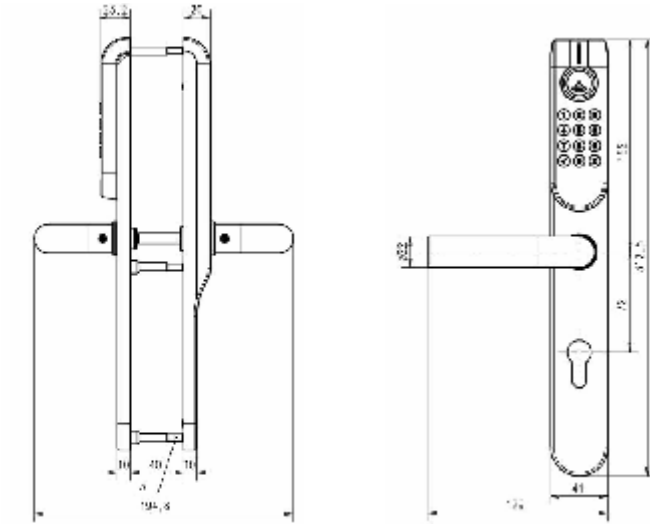

7. Package

E 100 is delivered in a card box package in white colour

- External escutcheon
- Internal escutcheon
- Communication hub
- Battery
- Installation manual
- Drilling template
- Screw set
- Hook to pull the cable through the door

Dimensions box: 355*253*48mm

Weight compl set: 1,3Kg

9. Change of Battery

- Battery is located in the inside escutcheon
- Remove handle (screw)
- Remove inside cover (2 screws)
- Replace battery, note polarity as indicated!!!

8. Warranty

According to Assa Abloy general terms and warranty conditions 2 years